

Property Description	
Lot Number	11
SP Number	174597
Parish	CLEVELAND
County	STANLEY
Authority	R.S.C

Method of Measurement for Leases:
 Measurements shown are as per surveyor drawings, and are in accordance with Property Council Guidelines: Gross Lettable Area Retail (GLAR).

HYDRAULIC SERVICES LEGEND

— SW —	SEWERAGE LINE
— TW —	TRADE WASTE
T/TD	TRAPPED TUNDISH
FW	FLOOR WASTE
SK	SINK
GVP	GREASE VENT PIPE
BN	BASIN
CW	COLD WATER
AC	AIR CONDITIONING TRAPPED TUNDISH
▨ EDB	ELECTRICAL DISTRIBUTION BOARD
⊕	DRAINAGE POINT
⊗ WM	WATER METER
IDF	INTERMEDIATE DISTRIBUTION FRAME (TELEPHONE CONNECTION)
IL	INVERT LEVEL

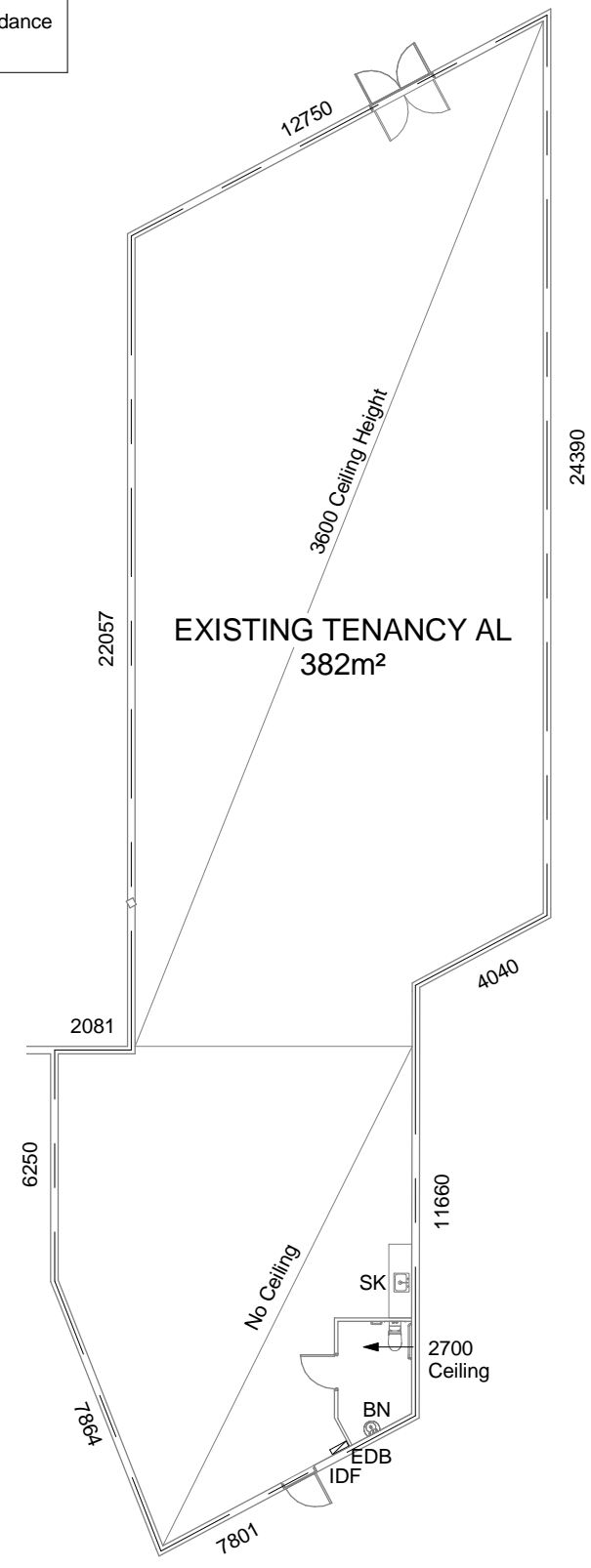

Existing Tenancy AL
 1 : 200

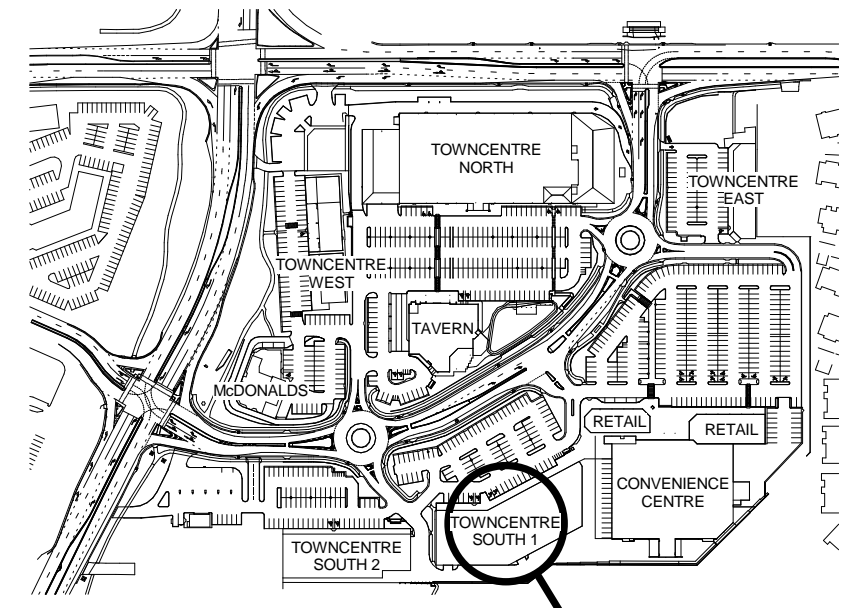

Site Locality Plan
 NOT TO SCALE
PROPOSED NEW TENANCY WORKS

"The Landlord accepts no responsibility for use & accuracy of "inherited drainage" as indicatively shown".
 All dimensions to be confirmed by site measure

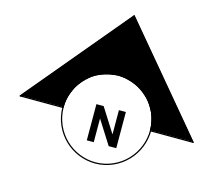

Existing Tenancy Area - Bld 1	
Name	Area
Tenancy AL	382

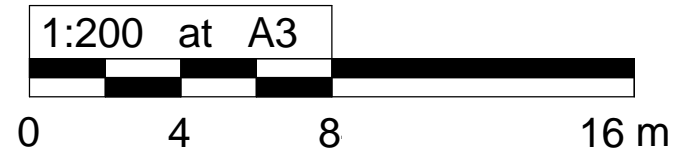

LANREX Property
 Property Investment
 Centre Management
 Retail Leasing

TownCentre Victoria Point
 349-369 Colburn Ave,
 Victoria Point Qld 4165

Issue	Issue Description	Date		
A	Existing Layout	18.12.15	Project number	A
			Date	18.12.15
			Drawn by	JPM
			Sheet	1.04
			LEASE PLAN	
			Tenancy AL	
			Indicative Layout	
			TownCentre South Building	